

# SANDWICH TYPE QUARTER TURN MANUAL OVERRIDE WORM GEAR BOX

Series : MO/MBO

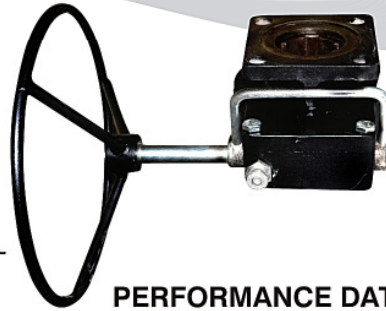
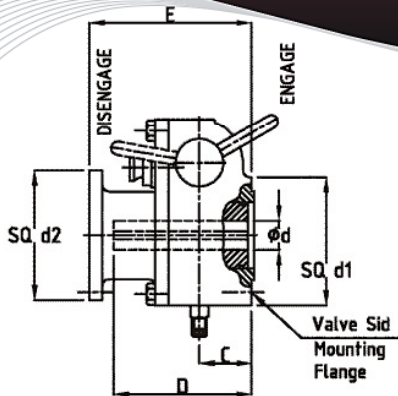
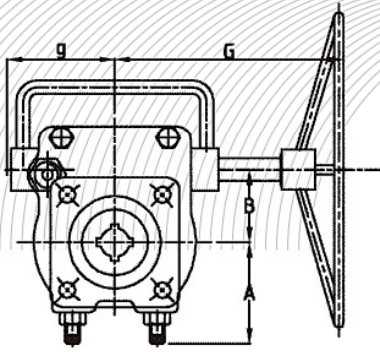

## DIMENSIONAL DATA

MODEL	A	C	E	ØF	G	g	Sq d1	Sq d2	MOUNTING FLANGES	
									Valve Side	Act. Side
MO 10	70	42.5	113	250	203	79	95	98	F7/F10	F7/F10
MO 12	100	49	134	300	250	80	126	126	F10/F12/F14	F10/F12/F14
MO 14	112	61	146	400	263	91	152	125	F12/F14/F16	F12/F14/F16

## PERFORMANCE DATA

MODEL	GEAR RATIO	OUTPUT TORQUE (Nm)	MECH Adv.	ød (max.)	D (max.)
MO10	29	500	9.0	36	101
M012	37	1200	11.5	50	126
M014	43	1680	12.1	50	140

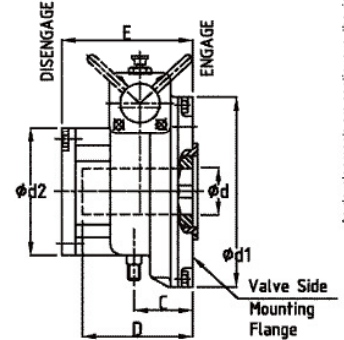
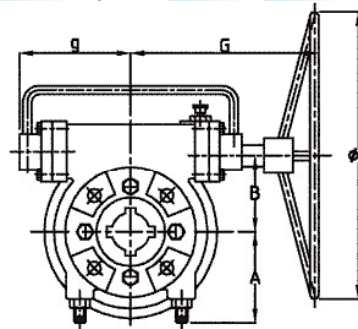
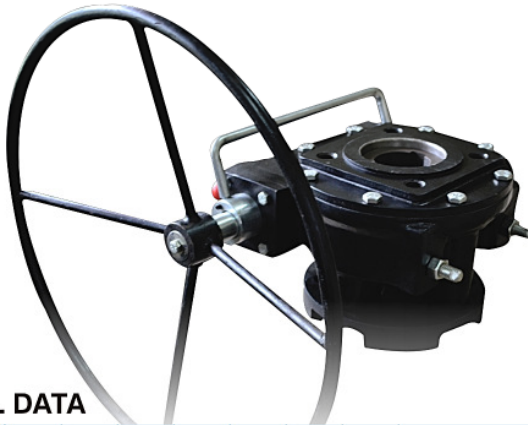

## DIMENSIONAL DATA

MODEL	A	C	E	ØF	G	g	ød1	ød2	MOUNTING FLANGES	
									Valve Side	Act. Side
MBO 13	117	66	166	400	253	148	235	210	F14/F16	F16
MBO 15	120	74	185	500	279	155	240	210	F14/F16	F16
MBO 20	165	77	247	600	370	240	339	220	F14/F16/F25	F16

## PERFORMANCE DATA

MODEL	GEAR RATIO	OUTPUT TORQUE (Nm)	MECH Adv.	ød (max.)	D (max.)
MBO13	50	2250	16.0	60	136
MBO15	51	2800	16.0	60	136
MBO20	54	4250	17.0	80	196

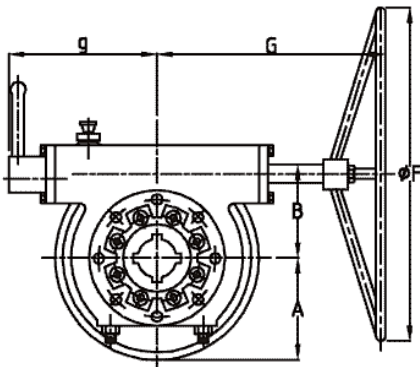

Note :  
Drawing for MBO 20

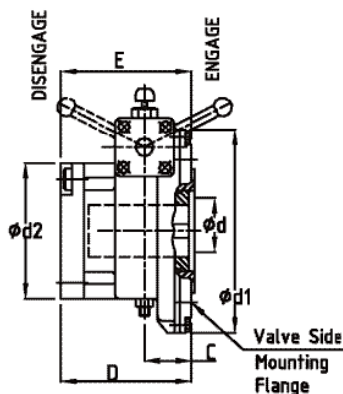

## MATERIAL OF CONSTRUCTION

PART NO.	PART NAME	MATERIALS
1	BODY	Cast Iron Gr.FG 220
2	COVER	Cast Iron Gr. FG 220
3	WORM	STEEL : En8
4	GEAR	SG IRON Gr 600/3
5	HANDWHEEL	ASTM A 53 / M.S.
6	INDICATOR	Cast Iron Gr.FG 220
7	Act. Mfg. Flange	Cast Iron Gr.FG 220
8	HANDWHEEL KEY	STEEL
9	BEARING BUSH	BRASS
10	BODY BOLTING	IS:1367 Gr. 8.8
11	O'RING	NITRILE
12	BEARING	TAPER ROLLER
13	GREASE	MP3 / AP3

## NOTE :

Other Materials not mentioned above or available on Request.



**SUPRIYA PROTOTECH**  
Range of Valves and Accessories

